



2 bed semi-detached house to buy in NE36

Don View, West Boldon, East Boldon, Tyne and Wear, NE36 0JA

£139,500

🏠 x2 🚗 x1 🚲 x1

Tenure

Freehold

On Street parking

Property features

- ✓ TWO BEDROOM SEMI DETACHED
- ✓ GAS CENTRAL HEATING AND DOUBLE GLAZED
- ✓ GREAT LOCATION AND AMENITIES
- ✓ NO ONWARD CHAIN AND VACANT POSSESSION
- ✓ EPC Rating D

Key Information

- ✓ Council Tax: Band A
- ✓ EPC Rating: D
- ✓ Heating supply: Gas
- ✓ Electric supply: National Grid
- ✓ Water supply: Direct mains water
- ✓ Broadband: ADSL copper wire
- ✓ Mobile signal: Good

Description

| TWO BEDROOM | SEMI DETACHED | GAS CENTRAL HEATING | GREAT LOCATION | VIEWING ESSENTIAL |

We are delighted to offer to the market this well presented two bedroom semi detached house on the popular Don View, West Boldon. Benefitting from gas central heating and double glazing the property has the added benefit of an enclosed rear gardens and great views over the burn.

Comprising briefly :- Upvc door to the entrance hallway with door to the lounge and stairs to the first floor landing. The kitchen/diner leads from the lounge and on to the conservatory/lean-too. To the first floor landing lie bedroom one, bedroom two and family bathroom.

Externally an enclosed garden lies to the rear with gardens to the front.

Offered for sale with no upper chain early viewing is essential...

Council Tax Band: A

Tenure: Freehold

Price: £139,500

Property Type: Semi-detached house

Parking: On Street

Year built: 1955

Construction materials: Brick and block

Roofing type: Clay tiles

Risk of floods and or erosion: No

Flooded in last 5 years: No

Flood defences: No

Planning permissions or proposals for development: No

Coalfield or mining area: Yes

Listed property: No

Conservation area: No

Public rights of way: No

Adaptions for accessibility: No

Restrictions: No

Required access: No

Heating: Gas

Electric: National Grid

Water: Direct mains water

Water meter: No

Sewerage: Standard UK domestic

Air conditioning: No

Broadband: ADSL copper wire, Cable, FTTC (fibre to the cabinet), FTTP (fibre to the premises)

Mobile signal coverage: Good

Entrance

Upvc door to the entrance hallway with doors to the lounge and stairs to the first floor landing.

Lounge

Double glazed window to the front and central heating radiator. Door to the kitchen.

Kitchen/diner

Fitted with a range of wall and base units with roll top work surfaces, stainless steel sink unit with mixer tap and splash back. Electric cooker point and plumbed for automatic washing machine. Double glazed window to the rear and door to the conservatory/lean-to.

Bedroom One.

Double glazed window to the front and central heating radiator.

Bedroom Two

Double glazed window to the rear and central heating radiator.

Bathroom

Comprising low level w.c., panelled bath and wash basin. Double glazed window to the rear central heating radiator.

External

An enclosed garden lies to the rear set to lawn with gardens to the front.

Approx Gross Internal Area
82 sq m / 888 sq ft

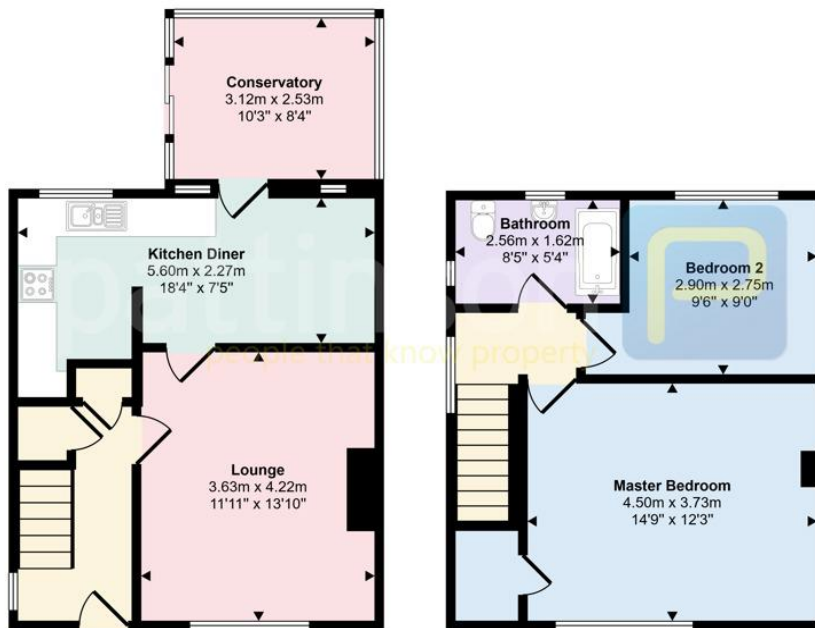

Ground Floor
Approx 45 sq m / 488 sq ft

First Floor
Approx 37 sq m / 400 sq ft

This floorplan is only for illustrative purposes and is not to scale. Measurements of rooms, doors, windows, and any items are approximate and no responsibility is taken for any error, omission or mis-statement. Icons of items such as bathroom suites are representations only and may not look like the real items. Made with Made Snappy 360.

Energy Efficiency Rating		Current	Potential
<i>Very energy efficient - lower running costs</i>			
(92-100) A			
(81-91) B			85
(69-80) C			
(55-68) D		53	
(39-54) E			
(21-38) F			
(1-20) G			
<i>Not energy efficient - higher running costs</i>			
England, Scotland & Wales		EU Directive 2002/91/EC	

Don View, West Boldon, East Boldon, Tyne and Wear, NE36 0JA

Contact your local branch today for more information on this property:
White Rose House, Thurston Road, Northallerton, North Yorkshire, DL6 2NA,
<https://www.alignsurveyors.co.uk/>

These particulars, whilst believed to be accurate are set out as a general outline only for guidance and do not constitute any part of an offer or contract. Intending purchasers should not rely on them as statements of representation of fact, but must satisfy themselves by inspection or otherwise as to their accuracy. No person in this firm's employment has the authority to make or give any representation or warranty in respect of the property.

