



3 bed end of terrace house to buy in NE23

Daisy Place, Cramlington, Cramlington,
Northumberland, NE23 8GP

£209,950

🏠 x3 🚗 x1 🚲 x1

Tenure

Freehold

Driveway parking

Property features

- ✓ Beautifully presented home
- ✓ No onward purchase
- ✓ Southerly facing garden
- ✓ Driveway for multiple vehicles
- ✓ EPC Rating B

Key Information

- ✓ Council Tax: Band B
- ✓ EPC Rating: B
- ✓ Heating supply: Gas

Description

Situated on a corner plot in the popular area of West Meadows, Cramlington, this beautifully presented three-bedroom home is an outstanding opportunity for buyers seeking a stylish and energy-efficient property. Finished to an excellent standard throughout, the home is decorated in neutral tones, creating an inviting and contemporary ambience that will appeal to a range of tastes.

The open-plan kitchen diner forms the heart of the property, ideally suited for modern living and perfect for both relaxing family meals and entertaining guests. Attention to detail is evident throughout, with high-quality finishes complementing the sense of space and light.

The southerly facing garden provides a wonderful outdoor retreat, ideal for summer gatherings or simply unwinding after work. The property is eco-conscious too, having been fitted with solar panels for enhanced energy efficiency and lower running costs.

Practicality is well catered for, with a driveway offering off-street parking for two cars, making daily life convenient from the moment you arrive. As a no onward purchase, the property offers a chain-free move, perfect for first-time buyers looking to step onto the ladder with ease.

Residents can enjoy an array of local amenities, green open spaces, and excellent transport links, making this location highly desirable for families and professionals alike.

Arrange a viewing today to fully appreciate everything this exceptional home has to offer.

Council Tax Band: B

Tenure: Freehold

Price: £209,950

Property Type: End of terrace house

Parking: Driveway

Heating: Gas

Entrance hallway

Cloaks W/C



Living Room



Kitchen/diner



Landing



Bedroom 1



Bedroom 2



Bedroom 3



Bathroom



Garden

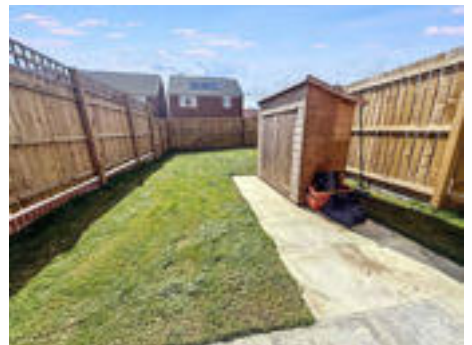

Approx Gross Internal Area
71 sq m / 769 sq ft

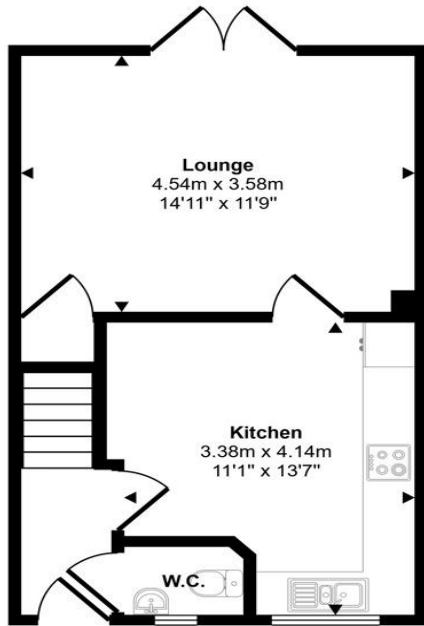

Ground Floor
Approx 36 sq m / 386 sq ft

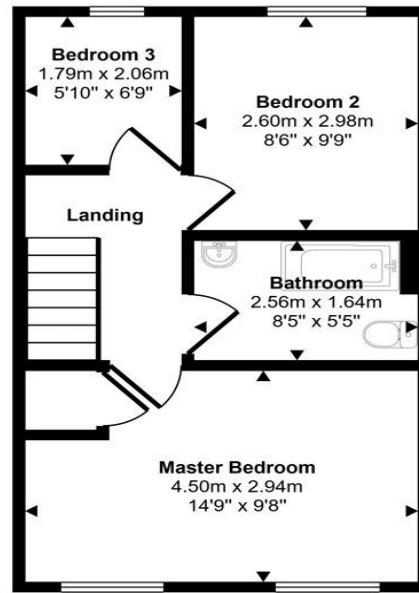

First Floor
Approx 36 sq m / 383 sq ft

This floorplan is only for illustrative purposes and is not to scale. Measurements of rooms, doors, windows, and any items are approximate and no responsibility is taken for any error, omission or mis-statement. Icons of items such as bathroom suites are representations only and may not look like the real items. Made with Made Snappy 360.

Energy Efficiency Rating		
	Current	Potential
<i>Very energy efficient - lower running costs</i>		
(92-100) A		
(81-91) B	91	91
(69-80) C		
(55-68) D		
(39-54) E		
(21-38) F		
(1-20) G		
<i>Not energy efficient - higher running costs</i>		
England, Scotland & Wales	EU Directive 2002/91/EC	

Daisy Place, Cramlington, Cramlington, Northumberland, NE23 8GP

Contact your local branch today for more information on this property:

White Rose House, Thurston Road, Northallerton, North Yorkshire, DL6 2NA,

<https://www.alignsurveyors.co.uk/>

These particulars, whilst believed to be accurate are set out as a general outline only for guidance and do not constitute any part of an offer or contract. Intending purchasers should not rely on them as statements of representation of fact, but must satisfy themselves by inspection or otherwise as to their accuracy. No person in this firm's employment has the authority to make or give any representation or warranty in respect of the property.

